

LEGEND

	EX. CABLE TV LINE
	EX. GAS SERVICE LINE
	EX. R.O.W. LINE
	FUTURE R.O.W. LINE
	EX. FENCE
	EX. WATER LINE
	EX. SANITARY SEWER LINE
	EX. ELECTRIC LINE
	EX. UNDERGROUND ELECTRIC LINE
	EX. SANITARY SEWER CLEANOUT
	EX. SANITARY SEWER MANHOLE
	EXIST. R.O.W. POINT
	EX. WATER VALVE
	EX. LIGHT POLE
	EX. UTILITY POLE
	EX. TRAFFIC POLE
	EX. FIRE HYDRANT
	EX. SIGN
	EX. CONCRETE SIDEWALK/PAVEMENT
	EX. RIP RAP
	EX. PAINTED STRIPING
	PROPOSED CONCRETE SIDEWALK/PAVEMENT
	PROPOSED AREA TO BE DEMOLISHED

DEMOLITION NOTES

- CONTRACTOR TO REMOVE ALL EXISTING TREES, SHRUBS, BRUSH, ASPHALT, CONCRETE, SIDEWALKS, TRAFFIC SIGNS, VEGETATION, DIRT, GRAVEL, ROCK, LIGHT POLES AND ETC. WITHIN THE DEMO AREA DEPICTED HEREON OR IN CONFLICT WITH NEW IMPROVEMENTS. ALL SAID MATERIALS REMOVED BY THE CONTRACTOR NOT INDICATED TO BE SALVAGED SHALL BECOME THE PROPERTY OF THE CONTRACTOR, UNLESS OTHERWISE DIRECTED BY THE PROJECT MANAGER OR OWNER AND SHALL BE REMOVED FROM THE PROPERTY IN A LEGAL AND APPROVED MANNER AT NO ADDITIONAL COST TO THE OWNER(S).
- ALL EXISTING UTILITIES SERVING FACILITIES THAT ARE TO REMAIN IN-PLACE DURING CONSTRUCTION MUST REMAIN OPERATIONAL THROUGHOUT CONSTRUCTION. THOSE UTILITIES THAT ARE LOCATED WITHIN THE DEMOLITION AREAS MUST BE PROTECTED AND MAINTAINED.
- ALL EXISTING UTILITIES TO FACILITIES TO REMAIN WHICH CROSS THE DEMOLITION AREA MAY REQUIRE RELOCATING OR REMOVAL.
- ANY EXISTING IMPROVEMENTS DAMAGED DURING CONSTRUCTION SHALL BE REPLACED BY THE CONTRACTOR AT CONTRACTORS EXPENSE WITH NEW TO MATCH EXISTING. ANY EXISTING ITEMS WHICH INTERFERE WITH CONSTRUCTION SHALL BE REMOVED AT THE CONTRACTOR'S EXPENSE WHETHER INDICATED HEREON OR NOT.

TBM# EL.= 499.19
 DIRECTIONAL ARROW ON FIRE HYDRANT SAID HYDRANT BEING LOCATED APPROXIMATELY 85 FEET NORTHEAST OF THE NORTHEAST CORNER OF THE CFSB CENTER AS SHOWN HEREON.
 VERTICAL DATUM B.M. ON CITY OF MURRAY CONTROL DATUM MONUMENT BM C5 2 (E.L. = 547.89, NAVD=88)

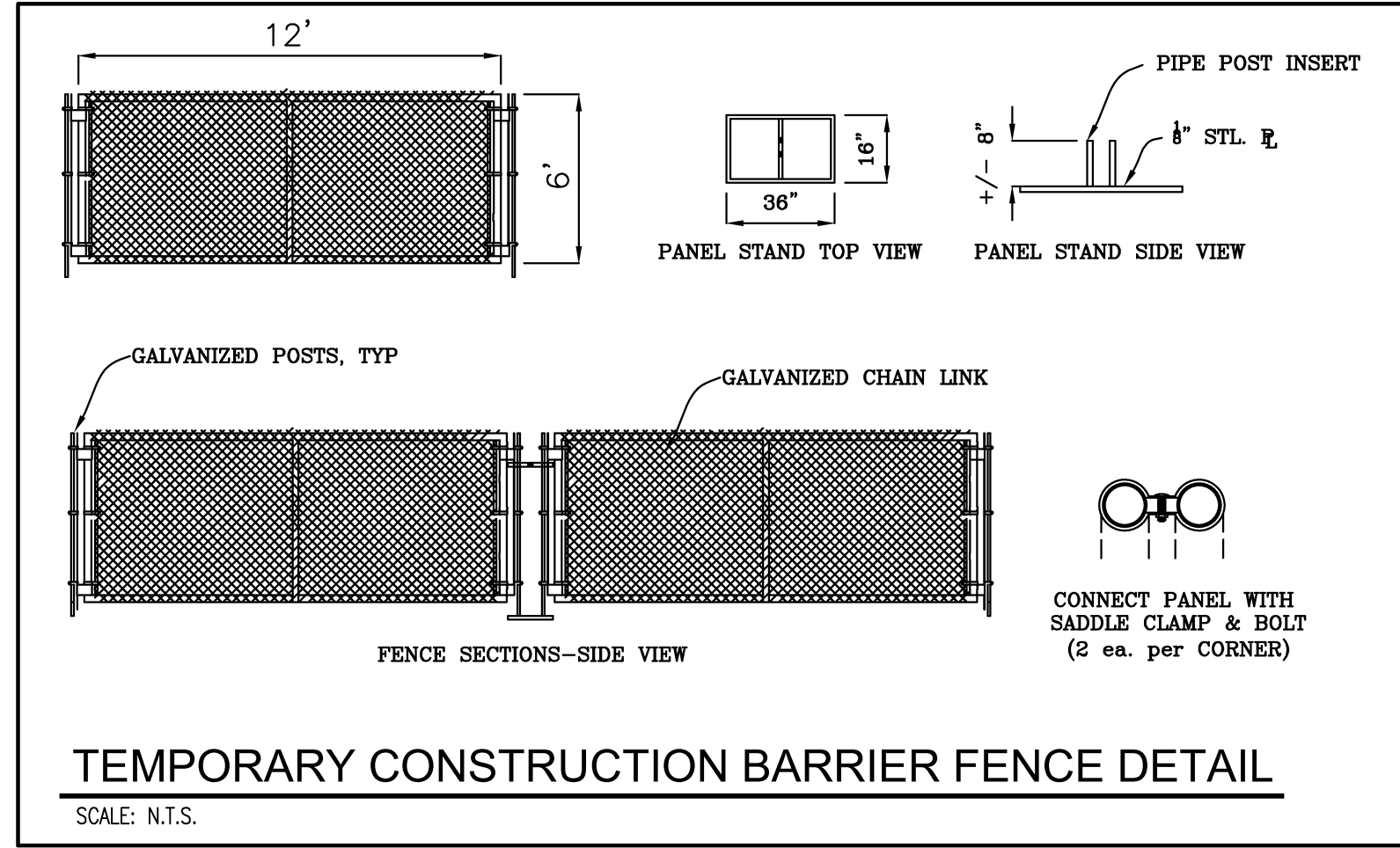

CONSTRUCTION FENCE NOTE:
 CONTRACTOR TO PLACE CONSTRUCTION FENCE OUTSIDE OF WORK LIMITS AND MODIFY IT'S LOCATION AS NEEDED THROUGHOUT CONSTRUCTION. THE CONTRACTOR IS SOLELY RESPONSIBLE FOR THE SAFETY OF THE SITE WHILE UNDER CONSTRUCTION. SEE DETAIL THIS SHEET.

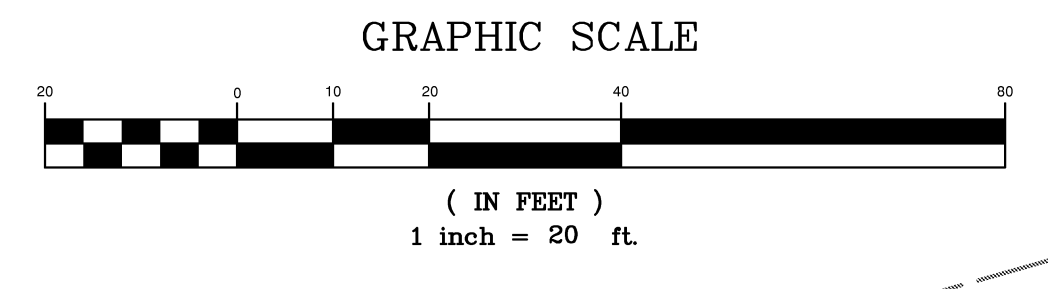

EXISTING STORM PIPING NOTE:
 THE LOCATION OF ALL EXISTING STORM WATER PIPING SHOWN ALONG THE NORTH SIDE OF THE EXISTING C.F.S.B. BUILDING SHOULD BE CONSIDERED APPROXIMATE ONLY. INFORMATION OBTAINED FROM "REGIONAL SPECIAL EVENTS CENTER, DATED: 4-7-95."

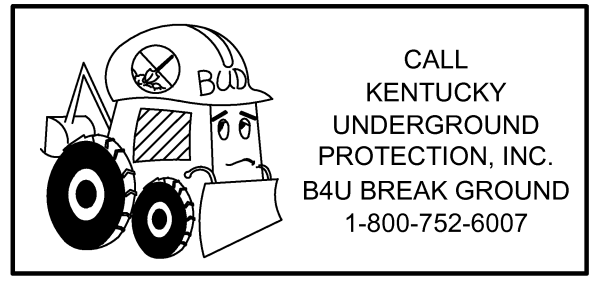
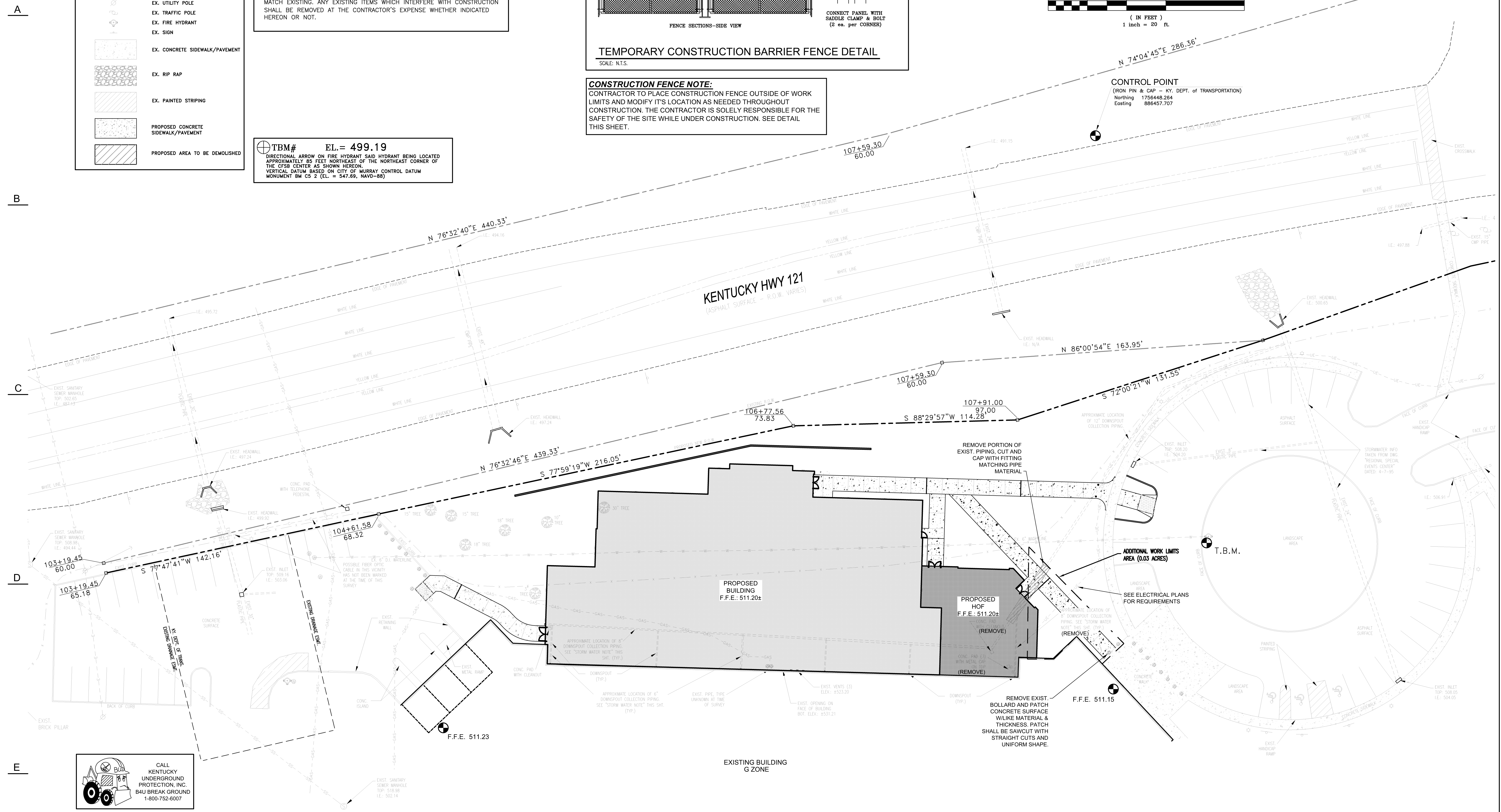

* CALL BEFORE YOU DIG "B.U.D." *

NOTE: PRIOR TO ANY EXCAVATION FOR UNDERGROUND UTILITIES, CONTRACTOR SHALL EXPOSE AND VERIFY LOCATIONS (HORIZONTAL AND VERTICAL) OF ALL EXISTING UTILITIES INCLUDING BUT NOT LIMITED TO GAS, WATER, AND SANITARY SEWER. ANY CONFLICTS SHALL BE REPORTED IMMEDIATELY TO THE ENGINEER AND THE APPROPRIATE AUTHORITIES.

NOTE: THE CONTRACTOR SHALL FIELD VERIFY THE LOCATION AND ELEVATION OF ALL UNDERGROUND UTILITIES PRIOR TO ANY EXCAVATION AND SHALL CONTACT THE KENTUCKY UNDERGROUND PROTECTION, INC. A MINIMUM OF TWO (2) WORKING DAYS PRIOR TO DIGGING AT TELEPHONE NO. 1-800-752-6007
 NO EXCAVATION SHALL COMMENCE UNTIL ALL APPLICABLE UTILITIES HAVE BEEN CLEARED.

BFW (FORMERLY GEOTECH ENGINEERING & TESTING, INC.)
BACON | FARMER | WORKMAN
 ENGINEERING & TESTING, INC.
 900 SOUTH 17th STREET | 403 NORTH COURT STREET | 1215 DULGIDD DRIVE
 PADUCAH, KY 42003 | MARION, IL 62959 | MURRAY, KY 42071
 PHONE: 270-443-1995 | PHONE: 618-997-9190 | PHONE: 270-752-7307

Hastings+Chivetta
 ARCHITECTURE • PLANNING • ENGINEERING
 CIVIL, BACON, FARMER, WORKMAN ENGINEERING & TESTING, INC., 1215 DULGIDD DRIVE, MURRAY, KENTUCKY 42071
 622 Emerson, Suite 200 | 1 South Lewis, Missouri 63241 | Tel: 314.883.2771 | Fax: 314.883.2823 | www.hastingschivetta.com
 3800 W. WOODLAWN, SUITE 100, OAK CREEK, IL 60451 | Tel: 708.486.1000 | www.hastingschivetta.com
 1101 W. WASHINGTON, SUITE 100, ST. LOUIS, MO 63101 | Tel: 314.433.1111 | Fax: 314.433.1112 | www.hastingschivetta.com
 1101 W. WASHINGTON, SUITE 100, ST. LOUIS, MO 63101 | Tel: 314.433.1111 | Fax: 314.433.1112 | www.hastingschivetta.com

MURRAY STATE UNIVERSITY
 FACILITIES DESIGN AND CONSTRUCTION
 DEPARTMENT FOR FACILITIES MANAGEMENT
 616 GURDNER DRIVE, MURRAY, KY 42071-3854
 MURRAY STATE UNIVERSITY
 1000 UNIVERSITY AVENUE, MURRAY, KY 42071-0001
 TEL: 270-222-2222 FAX: 270-222-2222

SPORTS PRACTICE FACILITY
 MURRAY STATE UNIVERSITY
 MURRAY, KENTUCKY
 BID SET - 2012-01-04

REVISIONS

Date -	2012-01-04
H+C Project No -	2983.00
FDC Project No -	10-007
BFW Project No -	11194
Marcom Project No -	11557

Sheet Name -
 SITE DEMOLITION
 PLAN - HALL OF FAME
 ALTERNATE

C1.06