

Hastings+Chivetta

ARCHITECTURE • PLANNING • ENGINEERING
6275 Embury, Suite 500 | Louisville, Kentucky 40228 | Tel: 502.486.5717 | Fax: 502.486.5833 | www.hastingschivetta.com

CIVIL, ARCHITECT, PLANNING, ENGINEERING & TESTING, INC., 1715 DUGGID DRIVE, MURRAY, KENTUCKY 42071
CIVIL, ARCHITECT, PLANNING, ENGINEERING & TESTING, INC., 465 N. COURT ST., MARION, ILLINOIS 62959
MPE-MARCUM ENGINEERING, LLC, 500 SOUTH 17TH STREET, PADUCAH, KENTUCKY, 40301

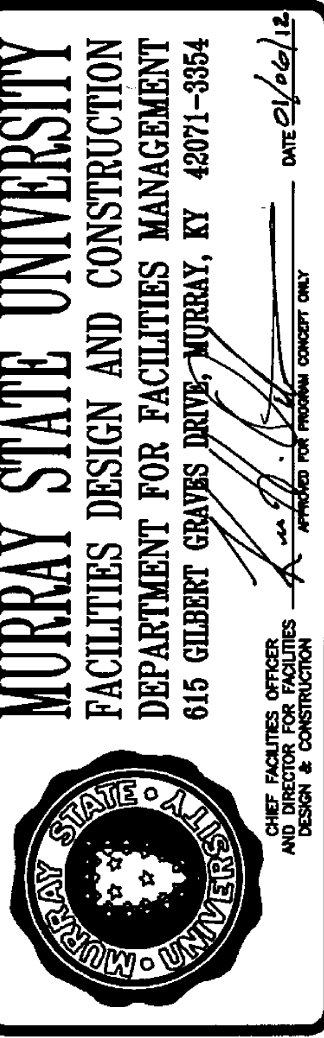

SPORTS PRACTICE FACILITY MURRAY STATE UNIVERSITY MURRAY, KENTUCKY BID SET - 2012-01-04



REVISIONS	
Date	2012-01-04
H+C Project No.	2983.00
FDC Project No.	10-007
BFW Project No.	11194
Marcum Project No.	11557
Sheet Name	CODE PLANS

AR2.02

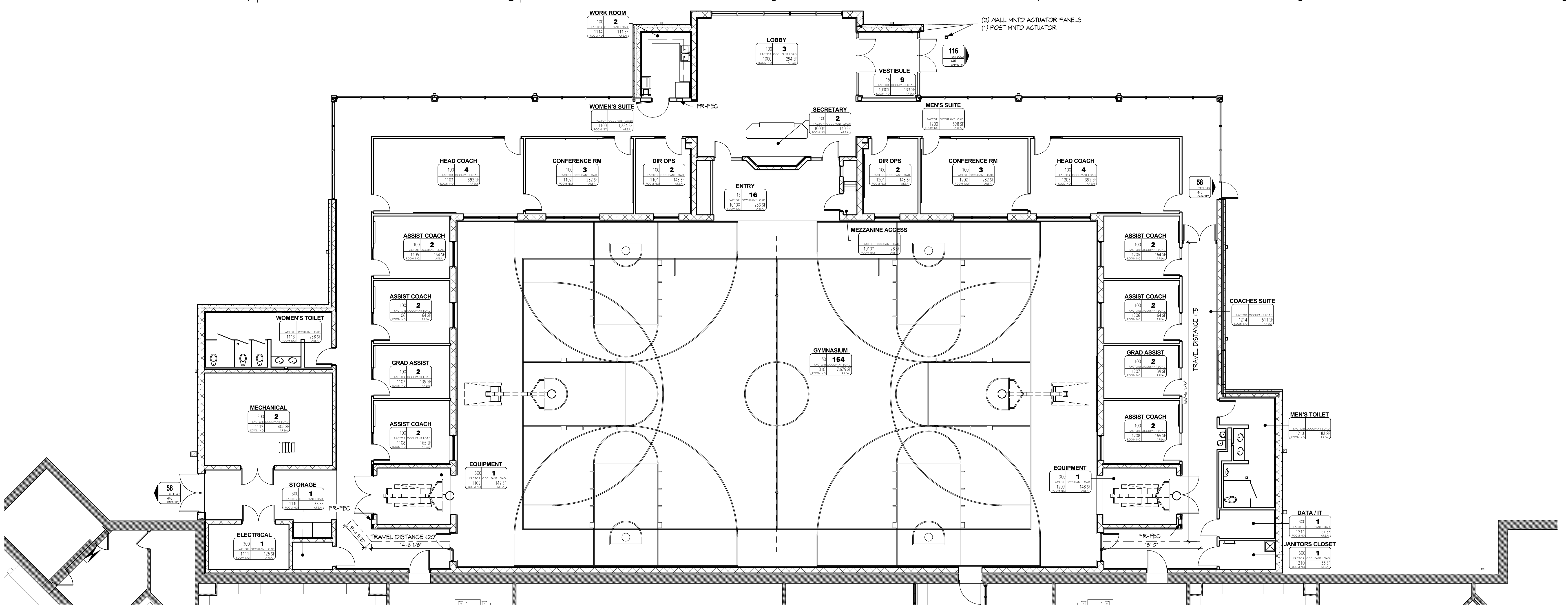

C LOWER LEVEL CODE PLAN
SCALE | 1/8" = 1'-0"

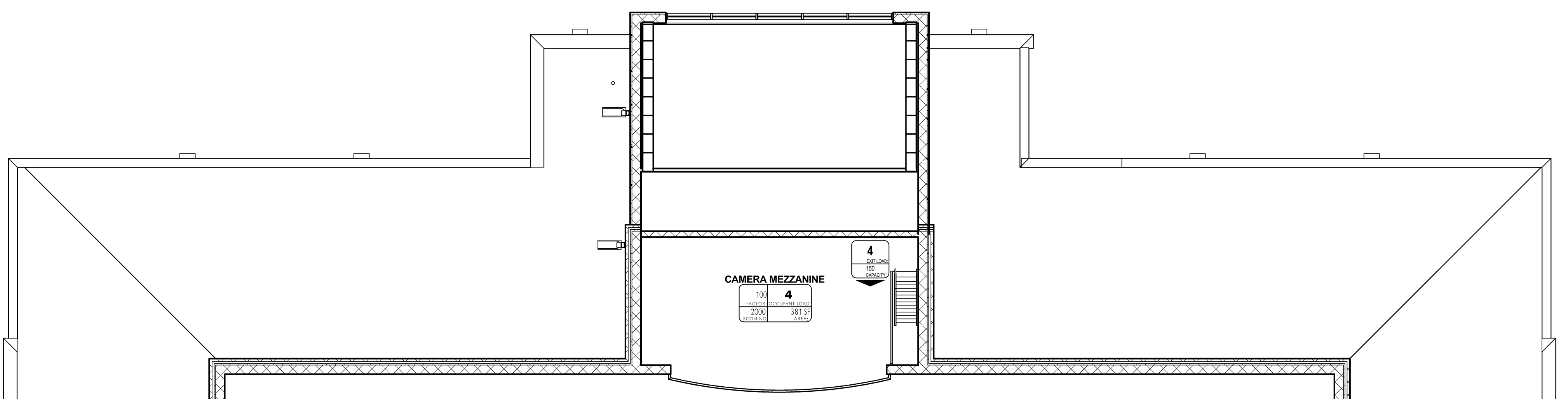

D CAMERA MEZZANINE CODE PLAN
SCALE | 1/8" = 1'-0"

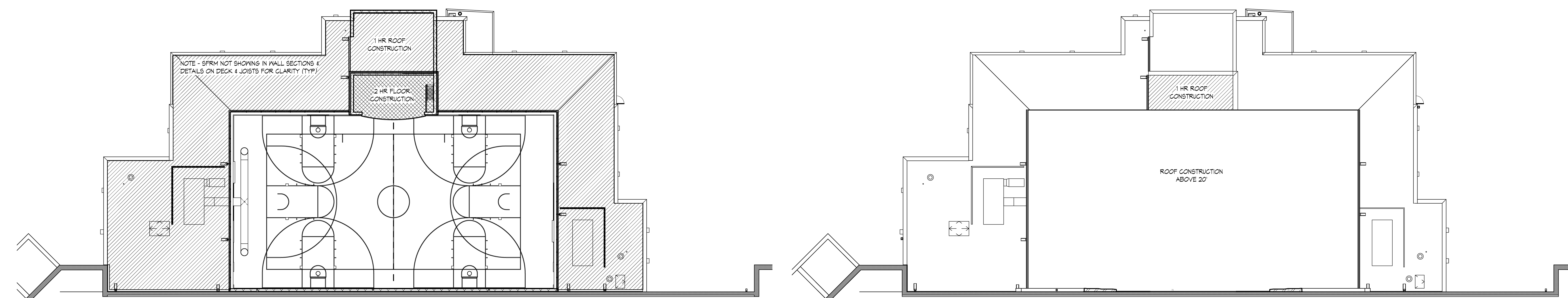

E RATING PLAN - LOW ROOF/FLOOR
SCALE | 1/16" = 1'-0"

F RATING PLAN - ROOF
SCALE | 1/16" = 1'-0"

C:\Users\jchivetta\Documents\Projects\2983.00 SP-2012\title.rvt
1/6/2012 3:58:35 PM